

Pneumatic Drive Bellows Pump & Auto Damper

HJS K-系列 波纹管泵(风囊泵) & 阻尼器 HJS K-Series Bellows Pump & Auto Damper



高品质及耐久性
High quality and Durability

- **流量稳定性, 应用温度范围广及耐久性**
Flow stability, Wide range of operating temperature and Durability



特殊优势
Special advantages

- **短交货期** (Short lead delivery times)
- **现有泵的可更换性** (Replaceability of existing pumps)
- **价格竞争力** (Price competitive)



容易维护
Easy maintenance

- **中国国内维修中心** (China's domestic maintenance center)

KP-30MC & KP-60MC

□ 中温·常温 兼用泵 (Bellows Pump)

Medium • Room-Temperature combined Bellows pump

KP-60MC



KP-30MC

应用范围 (Operating temperature)
10°C~100°C

最大流量 (Max Flow rate)
30L/min & 60L/min

价格竞争力
Price competitive

□ 流量 Pump Performance Curve

KP-30MC

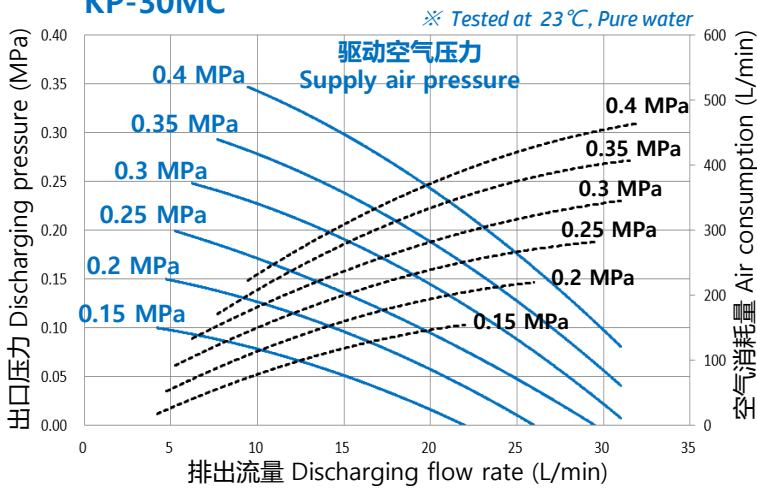

KP-60MC

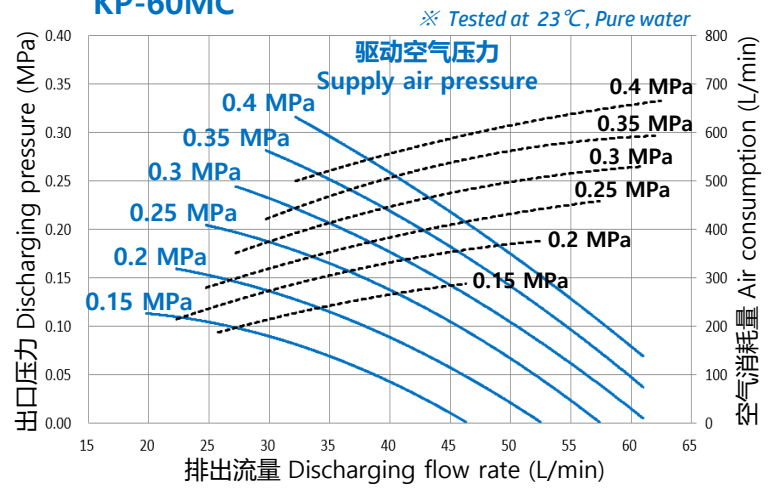

试验条件 Test conditions

- Supply air pipe size : Rc 3/8" (PT) Port (Tube O.D10 X I.D8 X 2M)
- Liquid pipe size : 3/4" Port (Tube O.D19 X I.D16)
- Test liquid : Pure water, 23°C

试验条件 Test conditions

- Supply air pipe size : Rc 1/2" (PT) Port (Tube O.D12 X I.D10 X 2M)
- Liquid pipe size : 1"Port (Tube O.D25 x I.D22)
- Test liquid : Pure water, 23°C

□ 驱动空气压力范围 Driving Air Pressure Range

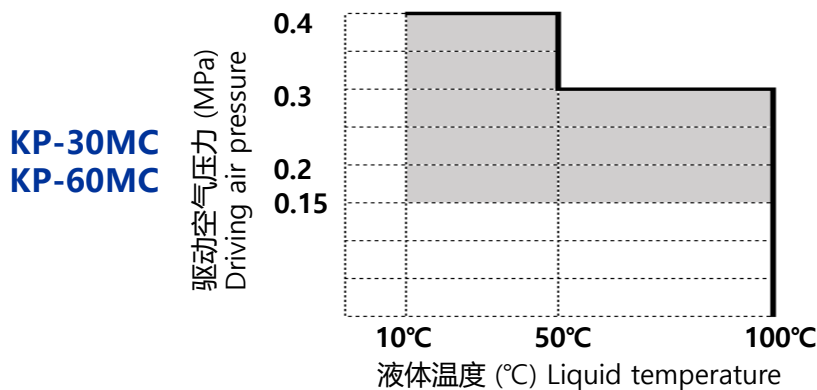

KP-30MC & KP-60MC

规格 Standard Specifications

Items / Models		KP - 30MC			KP - 60MC		
最大排出流量 (L/min) Max. discharging flow rate		(*Note.1) 30 L/min			(*Note.1) 60 L/min		
每冲程流量 (L/stroke) Flow rate per stroke		(*Note.2) 0.40 L/stroke			(*Note.2) 0.86 L/stroke		
液体温度使用范围 (°C) Temperature range of liquid		10 ~ 50°C	51 ~ 100°C		10 ~ 50°C	51 ~ 100°C	
驱动空气压力范围 (MPa) Driving air pressure range		0.15 ~ 0.4 MPa	0.15 ~ 0.3 MPa		0.15 ~ 0.4 MPa	0.15 ~ 0.3 MPa	
最大允许冲程速度 (spm) Max allowable Stroke speed		Max 75 stroke/min			Max 70 stroke/min		
驱动空气连接端 Air supply inlet ports		2-Rc 3/8" (PT)			2-Rc 1/2" (PT)		
液体连接端 Liquid connection ports		PTFE 3/4" (O.D 19 x I.D16mm)			PTFE 1" (O.D 25 x I.D 22mm)		
液体接触材质 Liquid contact materials		PTFE, PFA					
使用环境温度范围 Ambient temperature		5 ~ 50°C					
接近开关 传感器 Proximity switch	输出信号 Output type	NPN Output (N.O. mode)					
	电源 Power supply	DC 10~30V					

* Note.1) 最大排出流量是根据常温下纯水的最大冲程(Stroke)速度测定的值。

* Note.2) 1个冲程 (1 stroke) : 1次往复(1 reciprocating motion)

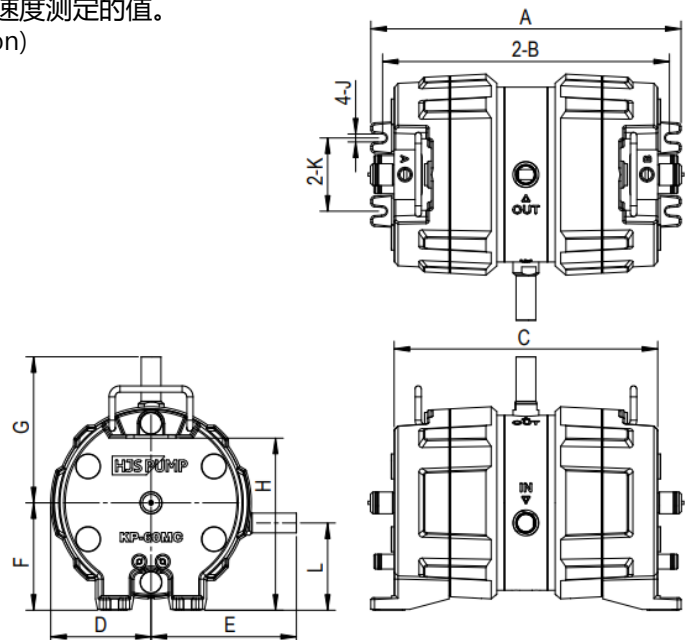
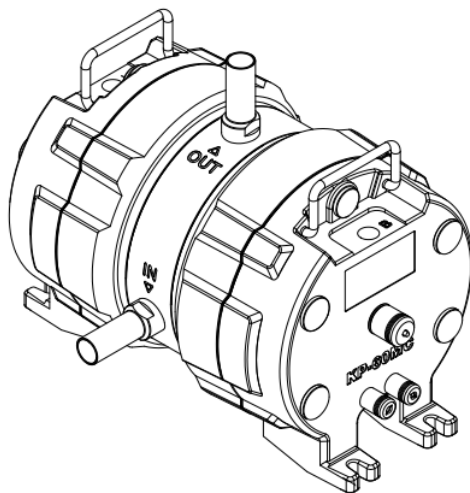

Models	A	B	C	D	E	F	G	H	J	K	L	Liquid in/out ports	Air supply ports	Weight
KP-30MC	386	360	326	108.5	163.5	119.0	165.5	182.0	10	80	95	3/4"	Rc 3/8" (PT)	20 Kg
KP-60MC	399	373	339	129.2	187.0	137.8	187.5	220.8	10	94	112	1"	Rc 1/2" (PT)	28 Kg

KP-30H & KP-60H

□ 高温·中温·常温 兼用泵 (Bellows Pump)

High • Medium • Room-Temperature combined Bellows pump

KP-60H



KP-30H

应用范围 (Operating temperature)
10°C~180°C

最大流量 (Max Flow rate)
30L/min & 60L/min

库存管理简便
Easy stock management

□ 流量 Pump Performance Curve

KP-30H

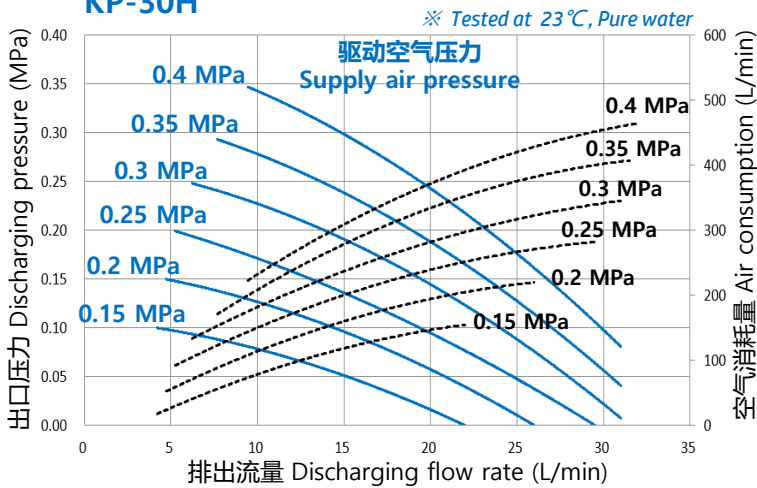

KP-60H

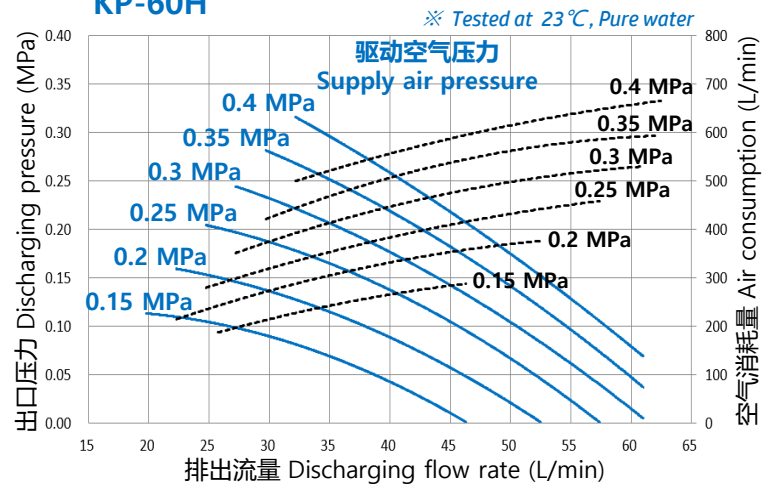

试验条件 Test conditions

- Supply air pipe size : Rc 3/8" (PT) Port (Tube O.D10 X I.D8 X 2M)
- Liquid pipe size : 3/4" Port (Tube O.D19 X I.D16)
- Test liquid : Pure water, 23°C

试验条件 Test conditions

- Supply air pipe size : Rc 1/2" (PT) Port (Tube O.D12 X I.D10 X 2M)
- Liquid pipe size : 1"Port (Tube O.D25 x I.D22)
- Test liquid : Pure water, 23°C

□ 驱动空气压力范围 Driving Air Pressure Range

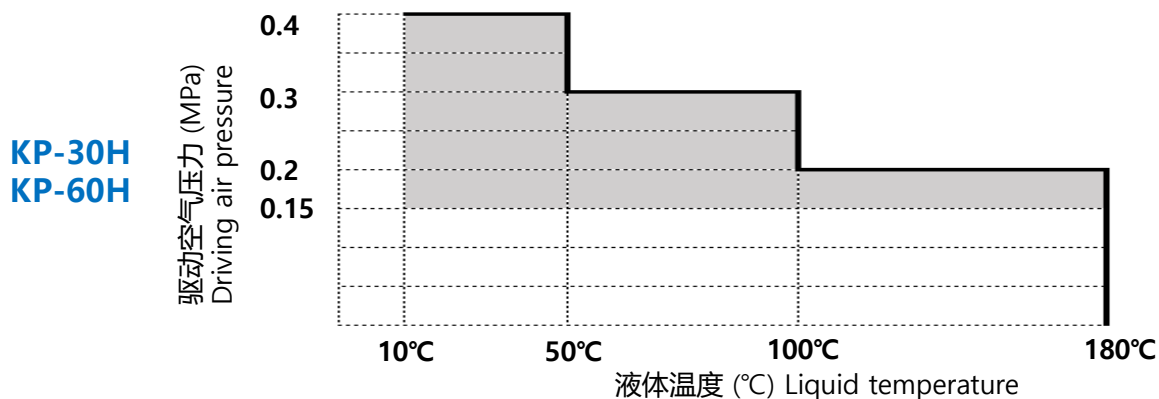

KP-30H & KP-60H

规格 Standard Specifications

Items / Models		KP – 30H			KP – 60H		
最大排出流量 (L/min) Max. discharging flow rate		(*Note.1) 30 L/min			(*Note.1) 60 L/min		
每冲程流量 (L/stroke) Flow rate per stroke		(*Note.2) 0.40 L/stroke			(*Note.2) 0.86 L/stroke		
液体温度使用范围 (°C) Temperature range of liquid		10 ~ 50°C	51 ~ 100°C	101 ~ 180°C	10 ~ 50°C	51 ~ 100°C	101 ~ 180°C
驱动空气压力范围 (MPa) Driving air pressure range		0.15 ~ 0.4 MPa	0.15 ~ 0.3 MPa	0.15 ~ 0.2 MPa	0.15 ~ 0.4 MPa	0.15 ~ 0.3 MPa	0.15 ~ 0.2 MPa
最大允许冲程速度 (spm) Max allowable Stroke speed		Max 75 stroke/min			Max 70 stroke/min		
驱动空气连接端 Air supply inlet ports		2-Rc 3/8" (PT)			2-Rc 1/2" (PT)		
液体连接端 Liquid connection ports		PTFE 3/4" (O.D 19 x I.D16mm)			PTFE 1" (O.D 25 x I.D 22mm)		
液体接触材质 Liquid contact materials		PTFE, PFA					
使用环境温度范围 Ambient temperature		5 ~ 50°C					
接近开关 传感器 Proximity switch	输出信号 Output type	NPN Output (N.O. mode)					
	电源 Power supply	DC 10~30V					

* Note.1) 最大排出流量是根据常温下纯水的最大冲程(Stroke)速度测定的值。

* Note.2) 1个冲程 (1 stroke) : 1次往复(1 reciprocating motion)

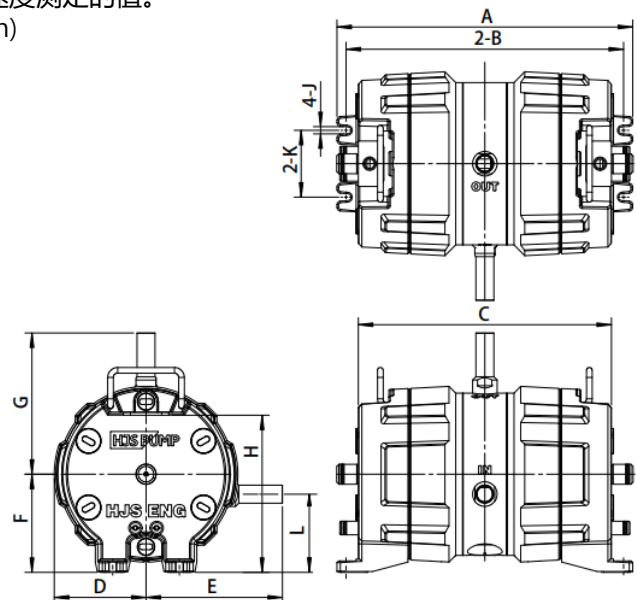
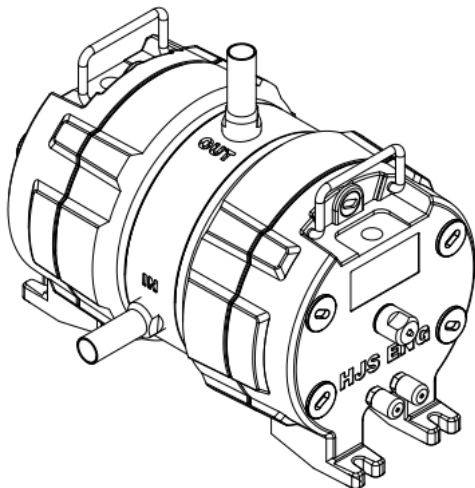

Models	A	B	C	D	E	F	G	H	J	K	L	Liquid in/out ports	Air supply ports	Weight
KP-30H	410.4	384.4	350.4	108.5	163.5	119.0	165.5	182.0	10	80	85.5	3/4"	Rc 3/8" (PT)	23 Kg
KP-60H	416.4	390.4	356.4	129.2	187.0	137.8	187.5	220.8	10	94	109.8	1"	Rc 1/2" (PT)	32 Kg

KD-30H & KD-60H

□ 阻尼器 (Auto Damper)

High • Medium • Room-Temperature combined Auto Damper

KD-60H



KD-30H

应用范围 (Operating temperature)
10°C~180°C

应用泵 (Applied pump)
KP-30H/30MC & KP-60H/60MC

库存管理简便
Easy stock management

Items / Models	KD – 30H			KD – 60H		
应用泵 Applied pump	KP-30H / KP-30MC			KP-60H / KP-60MC		
液体温度使用范围 (°C) Temp. range of liquid 空气供给压力范围 (MPa) Air supply pressure	应用泵 (Applied pump) : KP-30H			应用泵 (Applied pump) : KP-60H		
	10 ~ 50°C	51 ~ 100°C	101 ~ 180°C	10 ~ 50°C	51 ~ 100°C	101 ~ 180°C
	0.15 ~ 0.4 MPa	0.15 ~ 0.3 MPa	0.15 ~ 0.2 MPa	0.15 ~ 0.4 MPa	0.15 ~ 0.3 MPa	0.15 ~ 0.2 MPa
※ 向阻尼器(Damper)提供空气与泵(Pump)驱动的空气压力相同 Supply air to Damper at the same pressure as Pump-driven air						
液体温度使用范围 (°C) Temp. range of liquid 空气供给压力范围 (MPa) Air supply pressure	应用泵 (Applied pump) : KP-30MC			应用泵 (Applied pump) : KP-60MC		
	10 ~ 50 °C	51 ~ 100°C	N/A	10 ~ 50 °C	51 ~ 100°C	N/A
	0.15 ~ 0.4 MPa	0.15 ~ 0.3 MPa	N/A	0.15 ~ 0.4 MPa	0.15 ~ 0.3 MPa	N/A
※ 向阻尼器(Damper)提供空气与泵(Pump)驱动的空气压力相同 Supply air to Damper at the same pressure as Pump-driven air						
空气供给连接端 Air supply inlet ports	Rc 1/8" (PT)			Rc 1/4" (PT)		
液体连接端 Liquid connection ports	PTFE 3/4" (O.D 19 x I.D 16mm)			PTFE 1" (O.D 25 x I.D 22mm)		
液体接触材质 Liquid contact materials	PTFE, PFA					
使用环境温度范围 Ambient temperature	5 ~ 50°C					
脉动压力宽度 (MPa) Pulsation pressure width	≤ 0.06 MPa (液体粘度为 1~50mPa•s时) Within 0.06 MPa (in case liquid viscosity is within 1~50 mPa•s)					

KD-30H & KD-60H

□ 结构图 Structural Drawings

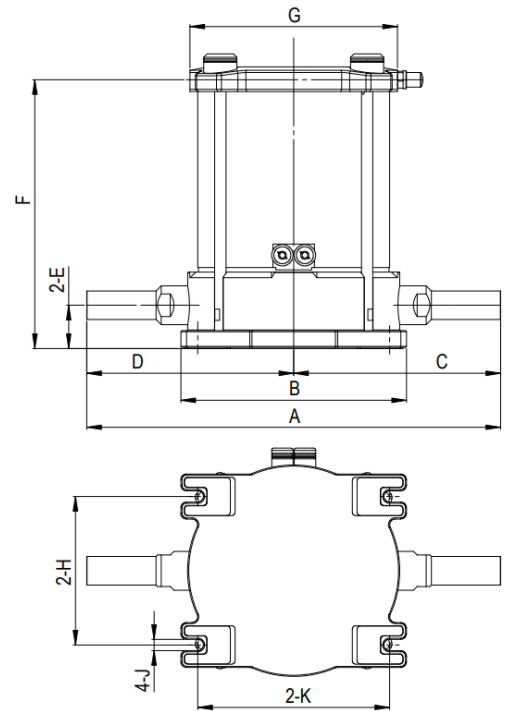
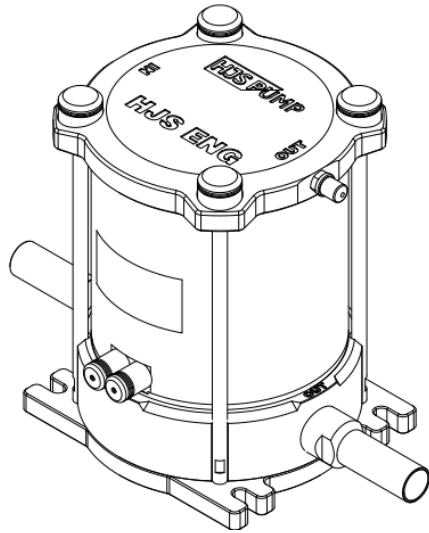

Models	A	B	C	D	E	F	G	H	J	K	Liquid in/out ports	Air supply ports	Weight
KD-30H	304.6	186	152.3	152.3	34.0	231.4	154	110	10	160	3/4"	Rc 1/8" (PT)	9 Kg
KD-60H	341.0	200	170.5	170.5	38.5	238.9	184	132	10	174	1"	Rc 1/4" (PT)	12 Kg

快速排气阀 Quick Exhaust Valve

□ 防止电磁阀被泵回气腐蚀，减少排气阻力

Prevent corrosion of solenoid valve by air returning from pump and reduce exhaust resistance

规格 Models	连接端 Connection ports	应用泵 Applied pump
KEV-R3	Rc 3/8" (PT)	KP-30MC, KP-30H, KA-C20M, KA-C20H, KA-S25M
KEV-R4	Rc 1/2" (PT)	KP-60MC, KP-60H, KA-C40M, KA-C40H, KA-S50M



KA-C20M & KA-C40M

低脉动泵 (清洗设备循环泵)

Low pulsation pump (Circulation pump for Cleaning equipment)

KA-C40M



KA-C20M

应用范围 (Operating Range)

最大流量: 20 & 40 L/min, 应用温度: 10°C~100°C

低脉动及稳定的流量 (Low pulsation, Stable flow)

过滤阻力降低 (Low filter resistance)

泵和阻尼器一体型, 减少安装空间

Pump & damper integration, Reduce installation space

流量 Pump Performance Curve

KA-C20M

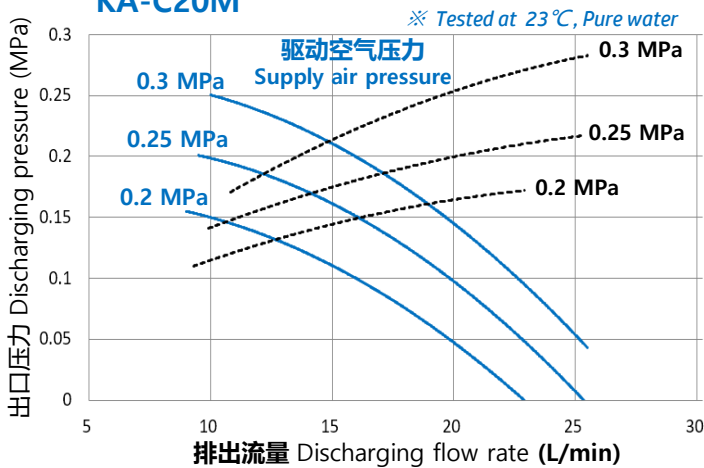

试验条件 Test conditions

- Supply air pipe size: Rc 3/8" (PT) Port (Tube O.D10 X I.D8 X 2M)
- Liquid pipe size: In port 3/4" (Tube O.D19 X I.D16)
Out port 3/4" (Tube O.D19 X I.D16)
- Test liquid: Pure water, 23°C

KA-C40M

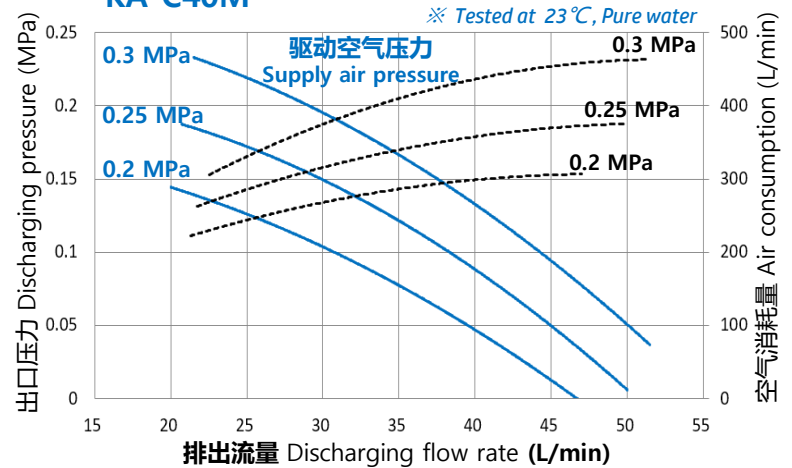

试验条件 Test conditions

- Supply air pipe size: Rc 1/2" (PT) Port (Tube O.D12 X I.D10 X 2M)
- Liquid pipe size: In port 1" (Tube O.D25 x I.D22)
Out port 1" (Tube O.D25 x I.D22)
- Test liquid: Pure water, 23°C

驱动空气压力范围 Driving Air Pressure Range

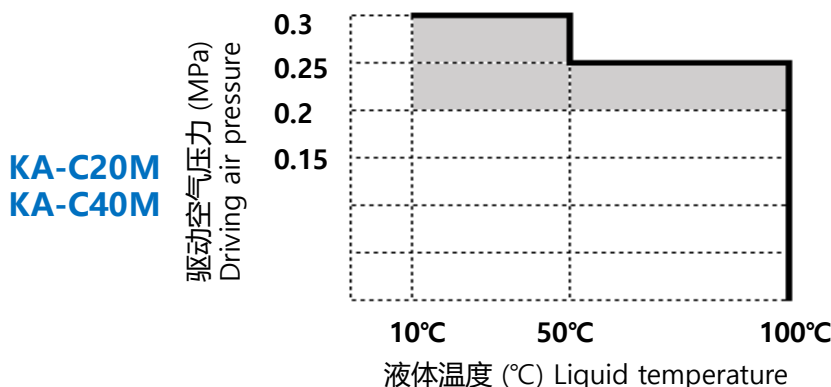

KA-C20M & KA-C40M

规格 Standard Specifications

Items / Models	KA - C20M			KA - C40M		
最大排出流量 (L/min) Max. discharging flow rate	(*Note.1) 20 L/min			(*Note.1) 40 L/min		
每冲程流量 (L/stroke) Flow rate per stroke	(*Note.2) 0.22 L/stroke			(*Note.2) 0.40 L/stroke		
液体温度使用范围 (°C) Temperature range of liquid	10 ~ 50°C	51 ~ 100°C		10 ~ 50°C	51 ~ 100°C	
驱动空气压力范围 (MPa) Driving air pressure range	0.2 ~ 0.3 MPa	0.2 ~ 0.25 MPa		0.2 ~ 0.3 MPa	0.2 ~ 0.25 MPa	
最大允许冲程速度 (spm) Max allowable Stroke speed	Max 105 stroke/min			Max 105 stroke/min		
驱动空气连接端 Air supply inlet ports	Pump Drive Air-In ports: 2-Rc 3/8" (PT) Damping Valve Air-In port : Rc 1/4" (PT)			Pump Drive Air-In ports: 2-Rc 1/2" (PT) Damping Valve Air-In port : Rc 1/4" (PT)		
液体连接端 Liquid connection ports	PTFE 3/4" (O.D 19 x I.D 16mm)			PTFE 1" (O.D 25 x I.D 22mm)		
液体接触材质 Liquid contact materials	PTFE, PFA					
使用环境温度范围 Ambient temperature	5 ~ 50°C					
接近开关 传感器 Proximity switch	输出信号 Output type	NPN Output (N.O. mode)				
	电源 Power supply	DC 12~24V				
脉动压力宽度 (MPa) Pulsation pressure width	≤ 0.06 MPa (液体粘度为 1~50mPa•s时) Within 0.06 MPa (in case liquid viscosity is within 1~50 mPa•s)					

* Note.1) 最大排出流量是根据常温下纯水的最大冲程(Stroke)速度测定的值。

* Note.2) 1个冲程 (1 stroke) : 1次往复(1 reciprocating motion)

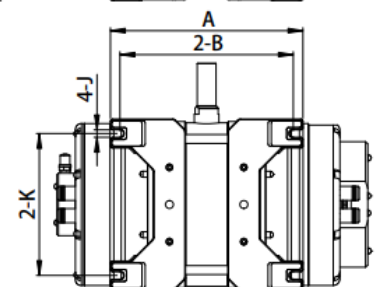
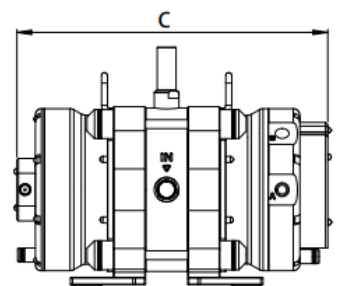
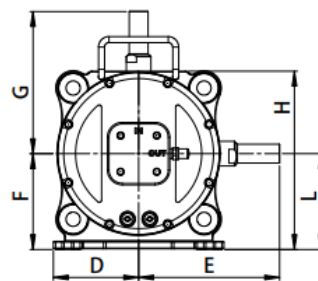
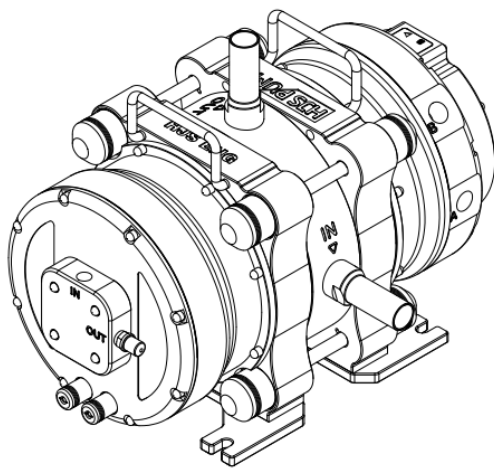

Models	A	B	C	D	E	F	G	H	J	K	L	Liquid in/out ports	Air supply ports	Weight
KA-C20M	241.0	217.0	401.6	102.5	173.5	115	173.0	215	10	166	115	In : 3/4" Out : 3/4"	Pump : Rc 3/8" (PT) Valve : Rc 1/4" (PT)	22 Kg
KA-C40M	259.6	235.6	419.1	115.0	190.0	129	191.5	240	10	191	129	In : 1" Out : 1"	Pump : Rc 1/2" (PT) Valve : Rc 1/4" (PT)	28 Kg

KA-C20H & KA-C40H

低脉动泵 (清洗设备循环泵)

Low pulsation pump (Circulation pump for Cleaning equipment)

KA-C40H



KA-C20H

应用范围 (Operating Range)

最大流量: 20 & 40 L/min, 应用温度: 10°C~180°C

低脉动及稳定的流量 (Low pulsation, Stable flow)

过滤阻力降低 (Low filter resistance)

泵和阻尼器一体型, 减少安装空间

Pump & damper integration, Reduce installation space

流量 Pump Performance Curve

KA-C20H

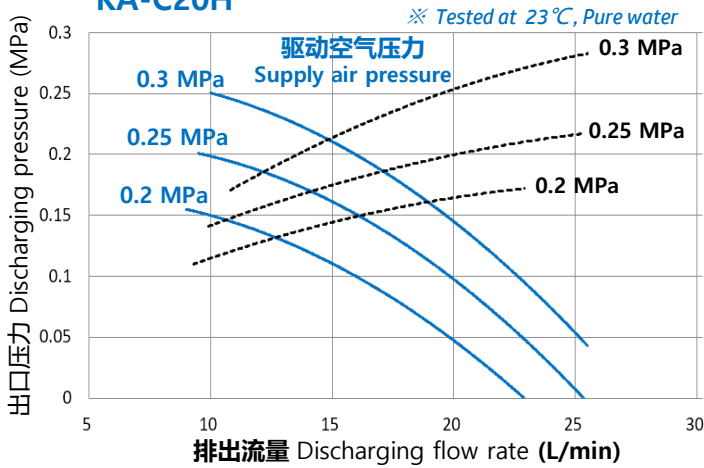

试验条件 Test conditions

- Supply air pipe size : Rc 3/8" (PT) Port (Tube O.D10 X I.D8 X 2M)
- Liquid pipe size : In port 3/4" (Tube O.D19 X I.D16)
Out port 3/4" (Tube O.D19 X I.D16)
- Test liquid : Pure water, 23°C

KA-C40H

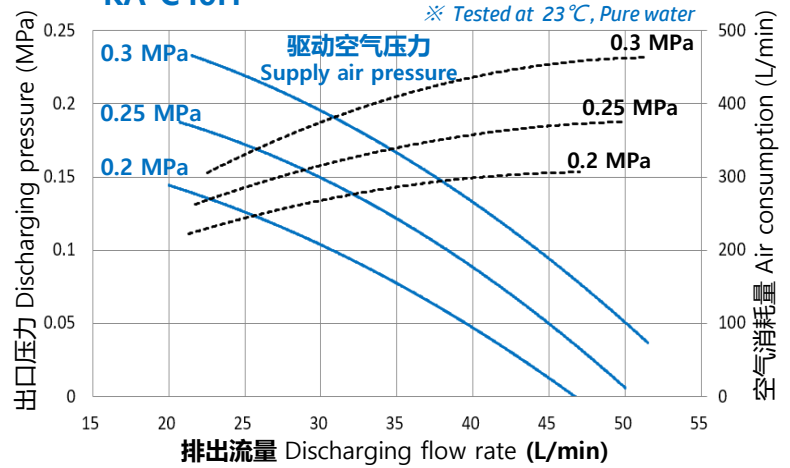

试验条件 Test conditions

- Supply air pipe size : Rc 1/2" (PT) Port (Tube O.D12 X I.D10 X 2M)
- Liquid pipe size : In port 1" (Tube O.D25 x I.D22)
Out port 1" (Tube O.D25 x I.D22)
- Test liquid : Pure water, 23°C

驱动空气压力范围 Driving Air Pressure Range

KA-C20H
KA-C40H

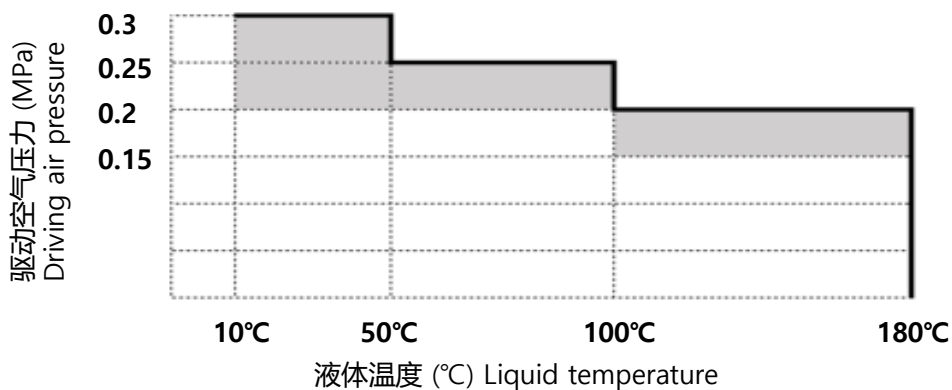

KA-C20H & KA-C40H

规格 Standard Specifications

Items / Models	KA - C20H			KA - C40H		
最大排出流量 (L/min) Max. discharging flow rate	(*Note.1) 20 L/min			(*Note.1) 40 L/min		
每冲程流量 (L/stroke) Flow rate per stroke	(*Note.2) 0.22 L/stroke			(*Note.2) 0.40 L/stroke		
液体温度使用范围 (°C) Temperature range of liquid	10 ~ 50°C	51 ~ 100°C	101 ~ 180°C	10 ~ 50°C	51 ~ 100°C	101 ~ 180°C
驱动空气压力范围 (MPa) Driving air pressure range	0.2 ~ 0.3 MPa	0.2 ~ 0.25 MPa	0.15 ~ 0.2 MPa	0.2 ~ 0.3 MPa	0.2 ~ 0.25 MPa	0.15 ~ 0.2 MPa
最大允许冲程速度 (spm) Max allowable Stroke speed	Max 105 stroke/min			Max 105 stroke/min		
驱动空气连接端 Air supply inlet ports	Pump Drive Air-In ports: 2-Rc 3/8" (PT) Damping Valve Air-In port : Rc 1/4" (PT)			Pump Drive Air-In ports: 2-Rc 1/2" (PT) Damping Valve Air-In port : Rc 1/4" (PT)		
液体连接端 Liquid connection ports	PTFE 3/4" (O.D 19 x I.D 16mm)			PTFE 1" (O.D 25 x I.D 22mm)		
液体接触材质 Liquid contact materials	PTFE, PFA					
使用环境温度范围 Ambient temperature	5 ~ 50°C					
接近开关 传感器 Proximity switch	输出信号 Output type	NPN Output (N.O. mode)				
	电源 Power supply	DC 12~24V				
脉动压力宽度 (MPa) Pulsation pressure width	≤ 0.06 MPa (液体粘度为 1~50mPa•s时) Within 0.06 MPa (in case liquid viscosity is within 1~50 mPa•s)					

* Note.1) 最大排出流量是根据常温下纯水的最大冲程(Stroke)速度测定的值。

* Note.2) 1个冲程 (1 stroke) : 1次往复(1 reciprocating motion)

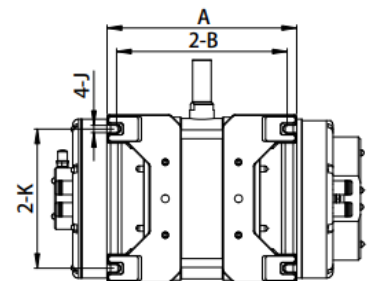
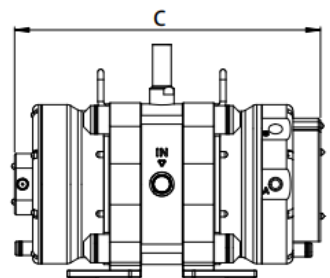
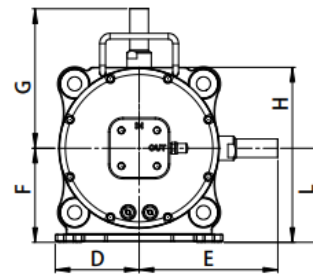
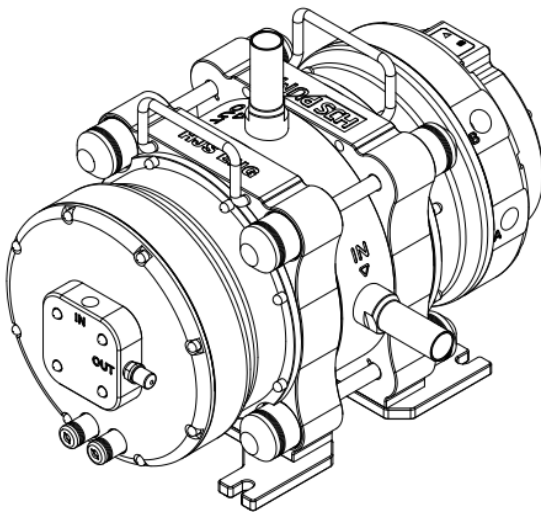

Models	A	B	C	D	E	F	G	H	J	K	L	Liquid in/out ports	Air supply ports	Weight
KA-C20H	249.0	225.0	409.6	102.5	173.5	115	173.0	215	10	166	115	In : 3/4" Out : 3/4"	Pump : Rc 3/8" (PT) Valve : Rc 1/4" (PT)	23 Kg
KA-C40H	259.6	235.6	419.1	115.0	190.0	129	191.5	240	10	191	129	In : 1" Out : 1"	Pump : Rc 1/2" (PT) Valve : Rc 1/4" (PT)	28 Kg

KA-S25M & KA-S50M

低脉动泵 (多种液体输送泵, Slurry 等)

Low pulsation pump (For various chemical supply system, Slurry etc.)



应用范围 (Operating Range)

最大流量: 25 & 50 L/min, 应用温度: 10°C~100°C

低脉动及稳定的流量 (Low pulsation, Stable flow)

过滤阻力降低 (Low filter resistance)

泵和阻尼器一体型, 减少安装空间

Pump & damper integration,

Reduce installation space

流量 Pump Performance Curve

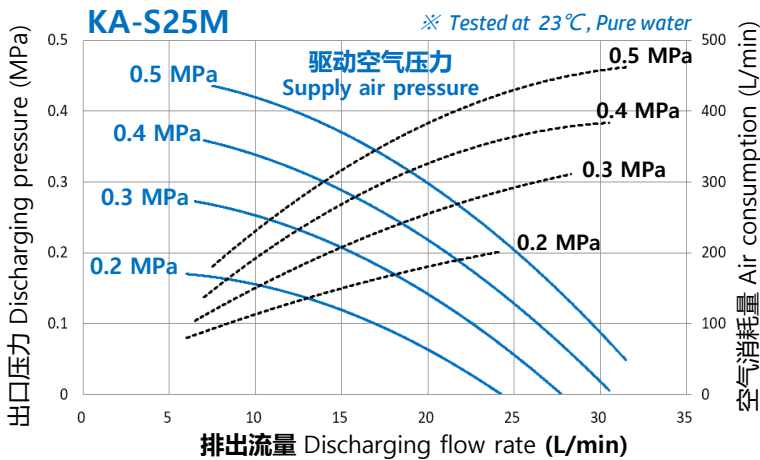

试验条件 Test conditions

- Supply air pipe size : Rc 3/8" (PT) Port (Tube O.D10 X I.D8 X 2M)
- Liquid pipe size : In port 1" (Tube O.D25 x I.D22)
Out port 3/4" (Tube O.D19 X I.D16)
- Test liquid : Pure water, 23°C

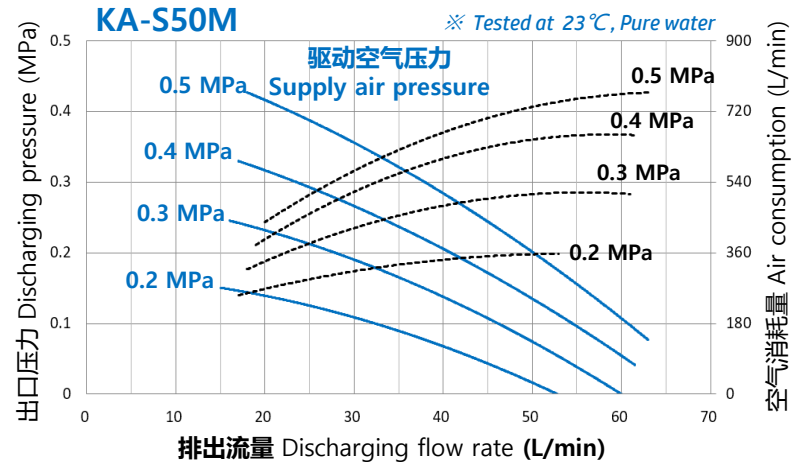

试验条件 Test conditions

- Supply air pipe size : Rc 1/2" (PT) Port (Tube O.D12 X I.D10 X 2M)
- Liquid pipe size : In port 1+1/2" (Tube O.D38x I.D34)
Out port : 1" (Tube O.D25 x I.D22)
- Test liquid : Pure water, 23°C

驱动空气压力范围 Driving Air Pressure Range

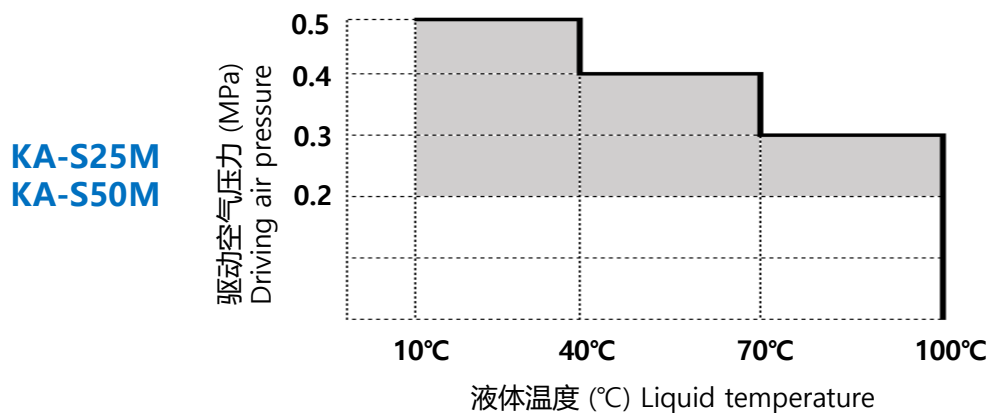

KA-S25M & KA-S50M

规格 Standard Specifications

Items / Models	KA – S25M			KA – S50M		
最大排出流量 (L/min) Max. discharging flow rate	(*Note.1)	25 L/min		(*Note.1)	50 L/min	
每冲程流量 (L/stroke) Flow rate per stroke	(*Note.2)	0.22 L/stroke		(*Note.2)	0.46 L/stroke	
液体温度使用范围 (°C) Temperature range of liquid	10 ~ 40°C	41 ~ 70°C	71 ~ 100°C	10 ~ 40°C	41 ~ 70°C	71 ~ 100°C
驱动空气压力范围 (MPa) Driving air pressure range	0.2 ~ 0.5 MPa	0.2 ~ 0.4 MPa	0.2 ~ 0.3 MPa	0.2 ~ 0.5 MPa	0.2 ~ 0.4 MPa	0.2 ~ 0.3 MPa
最大允许冲程速度 (spm) Max allowable Stroke speed	Max 115 stroke/min			Max 115 stroke/min		
驱动空气连接端 Air supply inlet ports	Pump Drive Air-In ports : 2-Rc 3/8" (PT) Damping Valve Air-In port : Rc 1/4" (PT)			Pump Drive Air-In ports : 2-Rc 1/2" (PT) Damping Valve Air-In port : Rc 1/4" (PT)		
液体连接端 Liquid connection ports	- In port : PTFE 1" (O.D 25 x I.D 22mm) - Out port : PTFE 3/4" (O.D 19 x I.D 16mm)			- In port : PTFE 1+1/2" (O.D 38 x I.D 34mm) - Out port : PTFE 1" (O.D 25 x I.D 22mm)		
液体接触材质 Liquid contact materials	PTFE, PFA					
使用环境温度范围 Ambient temperature	5 ~ 50°C					
接近开关 传感器 Proximity switch	输出信号 Output type	NPN Output (N.O. mode)				
	电源 Power supply	DC 12~24V				
脉动压力宽度 (MPa) Pulsation pressure width	≤ 0.06 MPa (液体粘度为 1~50mPa·s时) Within 0.06 MPa (in case liquid viscosity is within 1~50 mPa·s)					

* Note.1) 最大排出流量是根据常温下纯水的最大冲程(Stroke)速度测定的值。

* Note.2) 1个冲程 (1 stroke) : 1次往复(1 reciprocating motion)

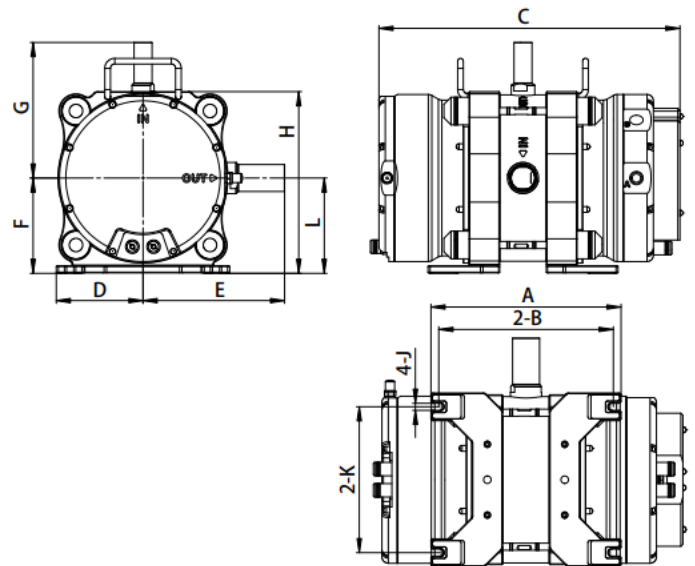
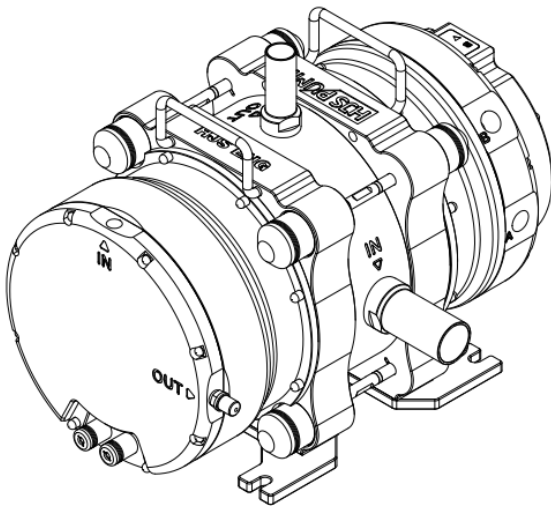

Models	A	B	C	D	E	F	G	H	J	K	L	Liquid in/out ports	Air supply ports	Weight
KA-S25M	249.0	225.0	405.5	102.5	180.5	115	173.0	215	10	166	115	In : 1" Out : 3/4"	Pump : Rc 3/8" (PT) Valve : Rc 1/4" (PT)	24 Kg
KA-S50M	268.6	244.6	425.3	122.5	200.0	135	191.5	257	10	206	135	In : 1+1/2" Out : 1"	Pump : Rc 1/2" (PT) Valve : Rc 1/4" (PT)	33 Kg

注意事项 Precautions

1. 结构图 (Structural Drawings)

本产品在生产过程中可能会发生部分变化，因此实际销售的产品和本目录的内容可能会存在一些差异。

(This product may be partially changed during mass production, so there may be some differences between the actual product being sold and the contents of this catalog.)

2. 压缩空气 (Compressed air)

在泵最近的位置减压后供给压缩空气。压缩空气对化学药品和使用的温度有限制。

(Supply the compressed air after reducing pressure at the nearest position of the pump. The compressed air has limitations as to chemicals and temperature to be used.)

3. 操作注意液体 (Chemicals to be handled with care)

产品用于下列化学溶液时，请与我们联系。根据使用条件，可能需要非标准规格的产品。

(If the product is used in the following chemical solutions, please contact us. Depending on the conditions of use, non-standard products may be required.)

- 1) 高渗透性化学品(Highly permeable chemicals) 包括盐酸(HCL)，硝酸(HNO₃)等：需要防腐蚀规格(Corrosion-proof)
(Highly permeable chemical including hydrochloric acid (HCL), nitric (HNO₃) acid, etc : Corrosion-proof is required.)
- 2) 溶剂系的溶液(Solvent)：需要防爆规格(Explosion-proof)
(Solvent : Explosion-proof is required.)
- 3) 高活性化学品包括联胺(Hydrazine)、发烟硫酸(Fuming sulfuric acid)及剥离液(Stripper)

公司网站 Company Website

Korean (한국어)



www.hjseng.com

Chinese (中文版)



www.hjseng.com

韩国 (Korean Office) :

HJS Eng CO.,LTD.

7-5, Gokhyeon-ro 855 beon-gil, Mohyeon-eup, Cheoin-gu, Yongin-si, Gyeonggi-do, Korea 17033

TEL : +82) 031-745-2425 / FAX : +82) 031-322-2413



中国 (Chinese Office) :

黄郑半导体 (山东) 有限公司 : HJS Eng (Shandong) Co.,Ltd.

山东省威海市火炬高技术产业开发区双岛路369-7号楼五楼西

电话 : +86) 0631-565-1898 / 传真 : +86) 0631-565-1897